



www.pumps.com.tw

JKCH series

5" Multi-Stage High Pressure Submersible Pumps

Liquid temperature : 0 °C to 40 °C / +32 °F to +104 °F

HP range : 1 to 1.8 HP / 750W to 1350 W

pH : 6 to 8

Protection class : IP68

Maximum immersion depth : 20M

Solid Pass : 1mm

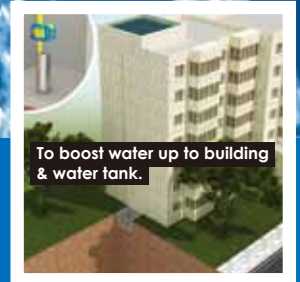

To boost water up to building & water tank.

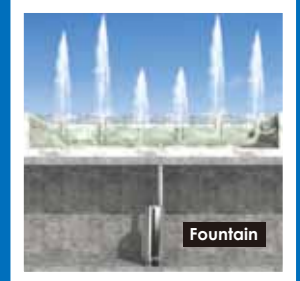

Fountain



Water system



Used for irrigation, gardening and residential and household water systems.



Combining the pressure controller & RO tank as a home booster system.

HUNG PUMP GROUP

High Pressure Pumps

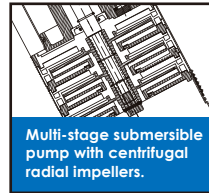
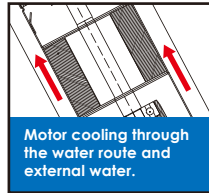
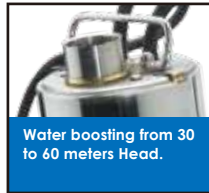
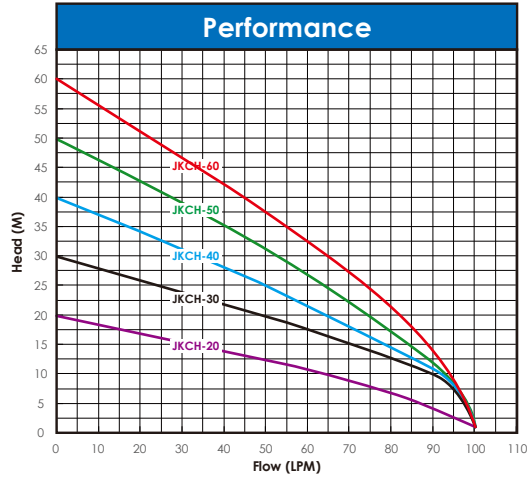
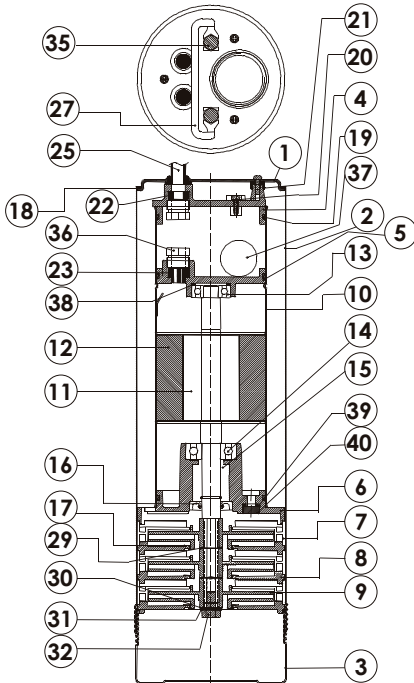

Construction					
No.	Description	Material	No.	Description	Material
1	Top Cover	SUS304	20	O-Ring	NBR
2	Outside Casing	SUS304	21	Packing	NBR
3	Strainer	SUS304	22	Packing	NBR
4	Cable Cover	SUS304	23	Packing	NBR
5	Bearing Cover	FC+Plating	25	Cord	
6	Bracket	FC+Plating	27	Handle	SUS304
7	Diffuser	PPO+GF	29	Washer	SUS304
8	Stop Plate	PPO+GF	30	Washer	SUS304
9	Impeller	PPO+GF	31	Spring Washer	SUS304
10	Motor Housing	SUS304	32	NUT	SUS304
11	Shaft	SUS410	35	Screw	SUS304
12	Stator	S.Plating+Wiring	36	Cable Head	NBR
13	Upper Bearing	CNM05K	37	Capacitor	PP
14	Lower bearing	CNM05K	38	Wave Spring	SC
15	Mech. Seal	CA/CE	39	Plug Packing	NBR
16	Oil Seal	NBR	40	Plug Screw	SUS304
17	Impeller Bushing	SUS304			
18	O-Ring	NBR			
19	O-Ring	NBR			

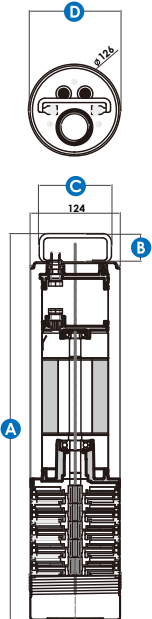
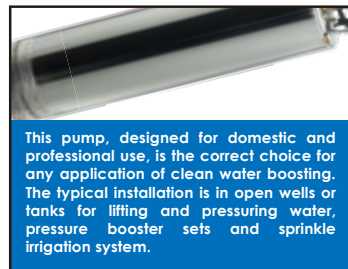

Dimension				
Model	A	B	C	D
JKCH-30	454	39	98	126
JKCH-40	478			
JKCH-50	530			
JKCH-60	530			

Specifications															
Model	Output		Stages	Outlet		Solid Pass Dia(mm)	Max Flow(LPM)	LPM Flow @ Head					Max Head(M)	Dimension L×W×H(mm)	Weight Kg
	HP	W		mm	Inch			5M	10M	20M	30M	40M			
JKCH-20	1/2	400	2	32	1-1/4"	1.2	100	87	65	-	-	-	20	125 x 125 x 430	11.8
JKCH-30	3/4	600	3	32	1-1/4"	1.2	100	97	90	50	-	-	30	125 x 125 x 454	12.8
JKCH-40	1.1	800	4	32	1-1/4"	1.2	100	97	92	60	35	-	40	125 x 125 x 478	13.8
JKCH-50	1.5	1100	5	32	1-1/4"	1.2	100	98	93	75	53	28	50	125 x 125 x 530	14.8
JKCH-60	1.8	1350	6	32	1-1/4"	1.2	100	98	95	83	55	45	60	125 x 125 x 554	15.8

Remarks: Model No. ends with "A" is equipped with float switch.